



HIVE

2 HURLINGHAM MEWS
14 MANOR ROAD
BOURNEMOUTH
BH1 3EY



“

Agent's introduction

Charming mid-terrace character cottage set within a small gated enclave on the East Cliff, just 0.5 miles from sandy beaches and Bournemouth Town Centre. Featuring two bedrooms, modern kitchen, en-suite, private garage and southerly communal gardens. Offered with no onward chain.

”



HIVE



HIVE



HIVE

Property highlights

- Character cottage in a small gated East Cliff development
- Set back from the road with southerly communal gardens
- 0.5 mile to award-winning sandy beaches
- 0.5 mile to Bournemouth Town Centre
- Living room and modern kitchen/breakfast room
- Two bedrooms, including en-suite to main
- Main bathroom, ensuite and cloakroom
- Private garage and residents' parking
- Shared south facing lawn with just four properties
- No onward chain – ideal as a main residence, second home or investment opportunity



Floor plan and EPC

Energy Efficiency Rating		
	Current	Potential
Very energy efficient - lower running costs		
(92 plus) A		87
(81-91) B		
(69-80) C	72	
(55-68) D		
(39-54) E		
(21-38) F		
(1-20) G		
Not energy efficient - higher running costs		
England & Wales		
EU Directive 2002/91/EC		

Approx Gross Internal Area
71 sq m / 762 sq ft

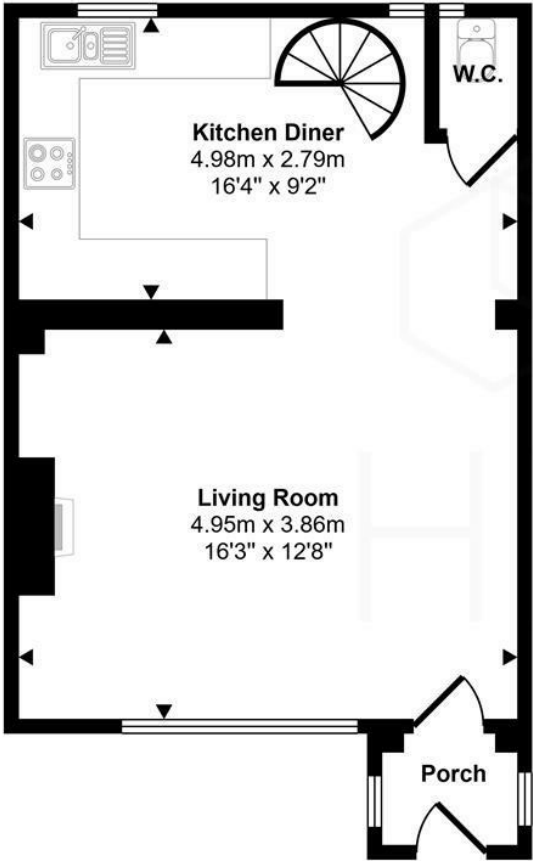

Ground Floor
Approx 36 sq m / 390 sq ft

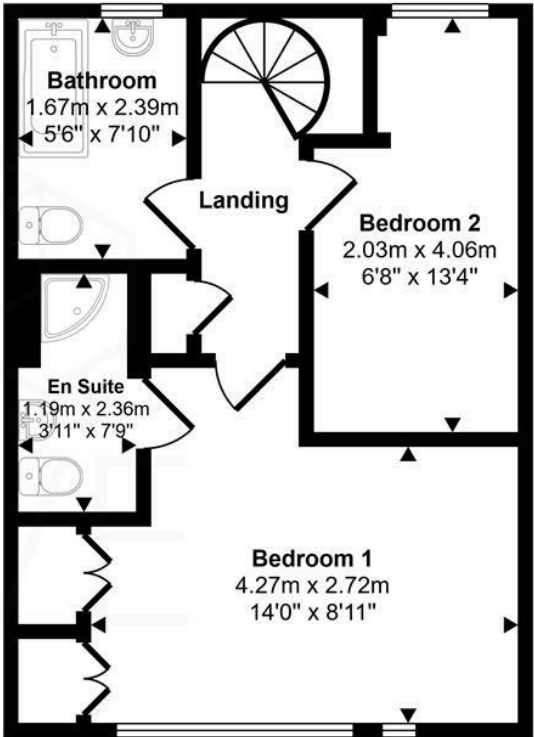

First Floor
Approx 35 sq m / 372 sq ft

This floorplan is only for illustrative purposes and is not to scale. Measurements of rooms, doors, windows, and any items are approximate and no responsibility is taken for any error, omission or mis-statement. Icons of items such as bathroom suites are representations only and may not look like the real items. Made with Made Snappy 360.





HIVE & Partners Unit F1, Arena Business Centre 9 Nimrod Way, Ferndown, BH21 7UH
01202 122 002 | www.hiveandpartners.co.uk | sales@hiveandpartners.co.uk